

THIS COPY IS PROVIDED ON A RESTRICTED BASIS AND IS NOT TO BE USED IN ANY WAY DETRIMENTAL TO THE INTERESTS OF PANDUIT CORP.

NOTES:

1. HIGH STRENGTH ELECTROLYTIC
COPPER HIGHLY RESISTANT TO
CORROSION AND SEASON CRACKING.
2. FOR COPPER AND COPPERWELD
WIRES ONLY.
3. *CONNECTOR CAN BE USED WITH
3 WIRES, BUT IS NOT CSA APPROVED
WITH 3 WIRES.
4. **THE CONDUCTOR SIZES SHOWN ARE FOR
EQUAL RUN AND TAP COMBINATIONS FOR
BOTH SOLID AND STRANDED UNLESS OTHERWISE
LISTED.

| CATALOG NUMBER | COPPER CONDUCTOR | | MAX CONDUCTOR | WIRE DIAMETER RANGE | | APPROXIMATE DIMENSIONS (IN INCHES) | | | | REQUIRED TORQUE (IN. - LB.) | |
|-------------------|-----------------------------|------------|-----------------------------|------------------------|--------|--|------|------|------|-----------------------------------|-------------|
| | RANGE OF EQUAL RUN & TAP | | MIN TAP WITH ONE MAX RUN | | | | | | | | COPPER WELD |
| | MIN. | MAX | | STR. | TYPE A | (IN INCHES) | A | B | C | | D |
| *SBC8L-C | 16 STR | 8 STR | 16 STR | ----- | ----- | .08-.15 | 0.15 | 0.38 | 0.5 | 0.84 | 80 |
| *SBC2L-C | 14 STR | 2 STR | 14 STR | 3 NO. 7 | 3A | .16-.29 | 0.33 | 0.63 | 0.81 | 1.55 | 275 |
| SBC750-1 | 350 kcmil | 750 kcmil | 8 SOL | 19 NO. 5 | ----- | .68-1.00 | 1.03 | 1.94 | 2.13 | 3.75 | 1000 |
| SBC1000-1 | 500 kcmil | 1000 kcmil | 8 SOL | ----- | ----- | .82-1.15 | 1.22 | 2.25 | 2.50 | 4.00 | 1100 |

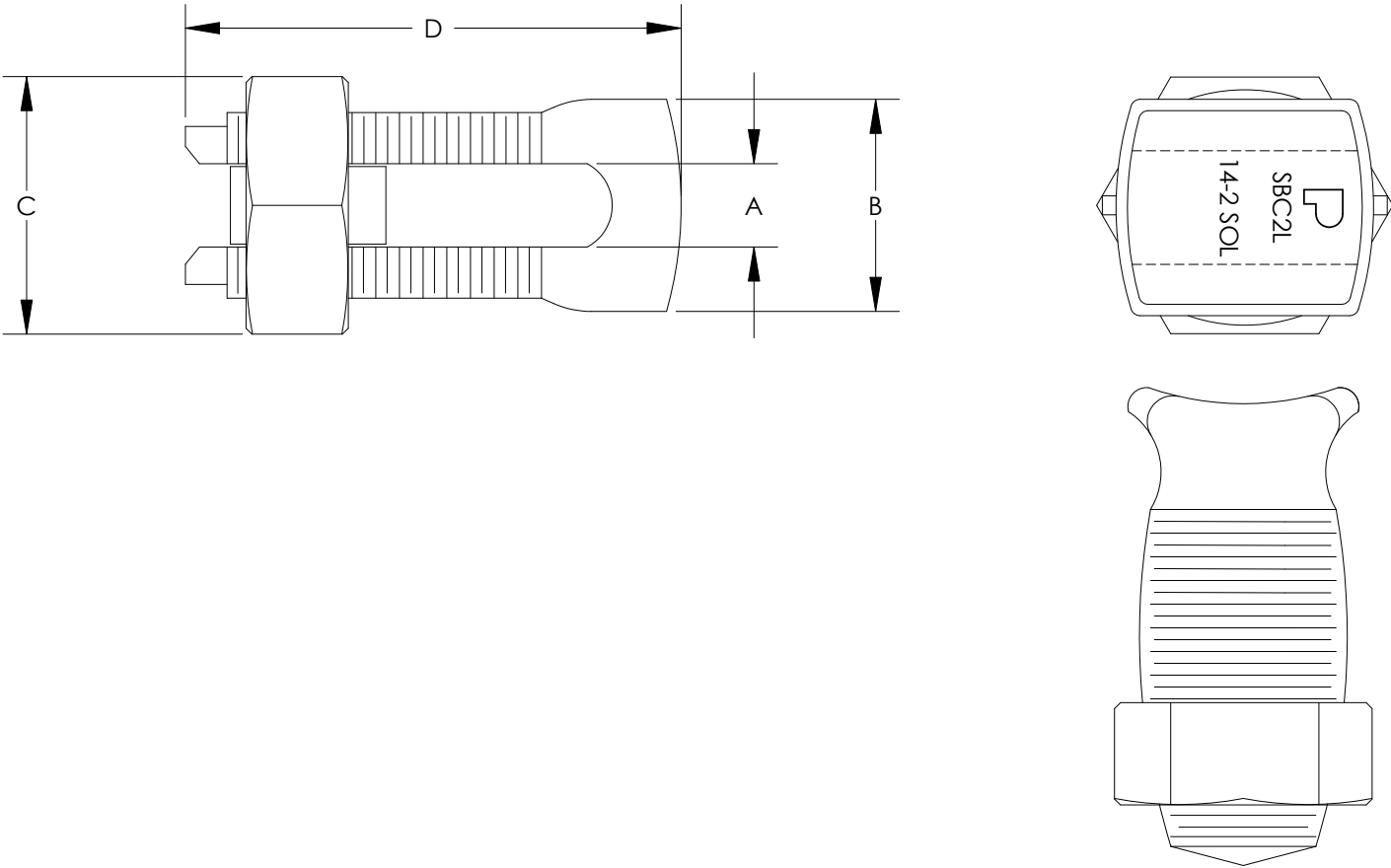
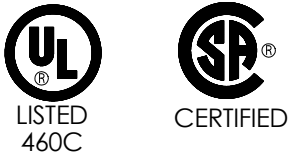

C41188_07

| | | | | | | | | | | | |
|-----|------|------|-----|---|-----------------|-----|-----|---|------------------------|--|------------------|
| | | | | | | | | PANDUIT CORP. TINLEY PARK, ILLINOIS | | | |
| | | | | | | | | SBC SERIES - COPPER SPLIT BOLT CONNECTOR CUSTOMER DRAWING | | | |
| | | | | | | | | UNLESS OTHERWISE SPECIFIED DIMENSIONAL TOLERANCES ARE: (.X) ± (.XXX) ± (.XX) ± ANGLES ± | | UNLESS OTHERWISE SPECIFIED, ALL DIMENSIONS ARE GIVEN IN INCHES, THIRD ANGLE PROJECTION | |
| 07 | 2/11 | JHNU | RWK | REV'D RANGE OF EQUAL RUN & TAP FOR SBC750-1: 350 kcmil MIN. WAS 8 SOL MIN. REV'D RANGE OF EQUAL RUN & TAP FOR SBC1000-1: 500 kcmil MIN. WAS 8 SOL MIN. | N10850BN-C41188 | FLD | FLD | DRAWN BY EJD | SEE NOTE 1 ABOVE | SCALE NONE | |
| | | | | | | | | DATE | | DRAWING NO / CAD FILE | DWG B SIZE |
| REV | DATE | BY | CHK | DESCRIPTION | ECN | -R | SUP | CHK'D | | C41188 | |

Mouser Electronics

Authorized Distributor

Click to View Pricing, Inventory, Delivery & Lifecycle Information:

[Panduit:](#)

[SBC750-1](#)