

Electronic housing - EMUG 22- BE - 2943479

Please be informed that the data shown in this PDF Document is generated from our Online Catalog. Please find the complete data in the user's documentation. Our General Terms of Use for Downloads are valid (<http://phoenixcontact.com/download>)

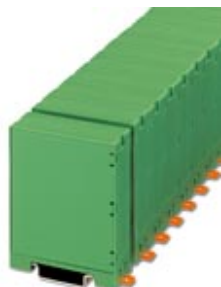

Base element with snap-on foot, for mounting on standard DIN rail, 22.5 mm wide

RoHS

Key Commercial Data

Packing unit	10 pc
GTIN	 4 017918 081119
GTIN	4017918081119

Technical data

General

Housing type	Component housing
Housing material	Polycarbonate fiber reinforced
Color (RAL)	green

Ambient conditions

Ambient temperature (operation)	-40 °C ... 125 °C
---------------------------------	-------------------

Dimensions

Length	60 mm
Width	22.5 mm
Depth	60 mm

Technical data

Number of positions	999
---------------------	-----

Standards and Regulations

Flammability rating according to UL 94	V0
--	----

Environmental Product Compliance

China RoHS	Environmentally friendly use period: unlimited = EFUP-e
------------	---

Electronic housing - EMUG 22- BE - 2943479

Technical data

Environmental Product Compliance

	No hazardous substances above threshold values
--	--

Drawings

Dimensional drawing

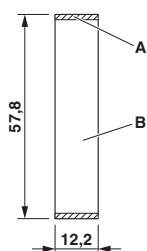

PCB 1 and 2 for EMUG 22 (horizontal)

A = PCB edge = 1.5 mm

B = Overall component area

Dimensional drawing

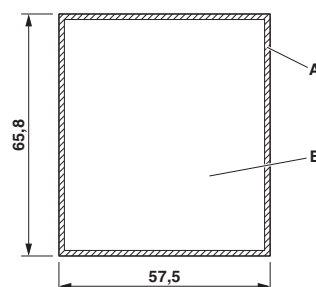

PCB 3 and 4 for EMUG 25 and EMUG 45 parallel to housing panel - side panel

A = PCB edge = 1.5 mm

B = Overall component area

Dimensional drawing

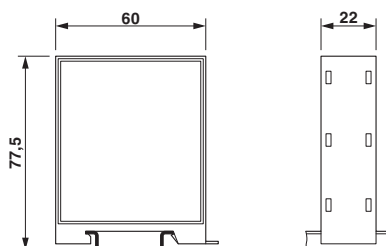

Phoenix Contact 2018 © - all rights reserved
<http://www.phoenixcontact.com>

PHOENIX CONTACT GmbH & Co. KG
Flachsmarktstr. 8
32825 Blomberg
Germany
Tel. +49 5235 300
Fax +49 5235 3 41200
<http://www.phoenixcontact.com>

Mouser Electronics

Authorized Distributor

Click to View Pricing, Inventory, Delivery & Lifecycle Information:

Phoenix Contact:

2943479